

USER GUIDE

CRANE BIN

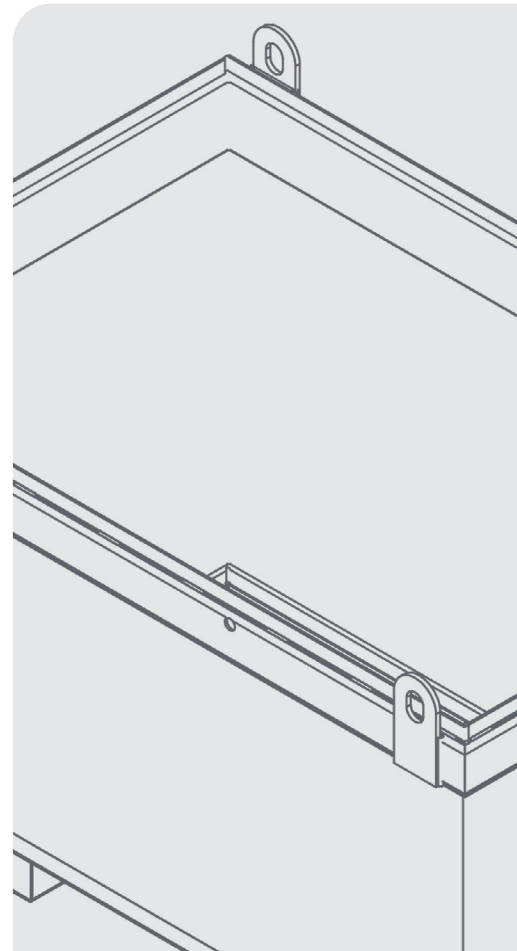

DISCLAIMER

Do not attempt to handle or operate this equipment before you have received sufficient training. Before use, operatives must have carried out all checks featured on the Visual Inspection Sheet on page 19. It is imperative that you have read the General Safety Instructions on page 20 and sufficiently familiarised yourself with the Operational Procedures in this document.

Note that this item is compliant only to the standards specified in this User Guide and it is therefore the duty of the responsible person(s) to review and ensure compliance.

CONTENTS

PRODUCT INFORMATION

INTRODUCTION	04
SPECIFICATION	05
PARTS DIAGRAM	09

OPERATIONAL PROCEDURES

IMPORTANT USAGE NOTES	12
LIFTING WITH A CRANE	13
LIFTING WITH A FORKLIFT	13
USING THE CONCRETE BLOWOUT LID	14

MAINTENANCE & INSPECTION

MAINTENANCE REGIME	18
VISUAL INSPECTION SHEET	19

GENERAL SAFETY INSTRUCTIONS

SAFETY INSTRUCTIONS	20
GENERAL NOTES	21

LEGAL

TERMS AND CONDITIONS	22
EC DECLARATION OF CONFORMITY	26
STANDARDS AND REGULATIONS APPLICABLE	27

INTRODUCTION

OVERVIEW

The Conquip Crane Bin is a heavy-duty crane-lift waste disposal bin for construction sites. Robust and easy to use, our range of bins is available in multiple sizes to suit varying applications on-site.

Each size features lifting points, allowing the bin to be lifted and discharged safely using a crane, and four-way entry fork pockets for easy access and manoeuvre around site with a forklift or telehandler.

All sizes are available with a concrete blowout lid, providing a safe and simple way to blowout concrete pump lines after use. Enabling blowout directly into a Crane Bin allows the excess concrete from the pump line to be reused, rather than going to waste.

Stackable and customisable with castor wheels, Conquip Crane Bins provide an efficient solution to waste management on any site.

KEY BENEFITS

- Designated lifting points for safe crane lifting and bin discharge.
- Robust, heavy-duty design to withstand rigours of construction sites.
- A range of sizes to suit varying site demands.
- The full range is available with concrete washout lids to facilitate the blowout of pump lines.
- The blowout lids feature crane lifting points and fork pockets for easy placement and locking chains to secure the lid to the bin.
- A variety of waste pipe kits for concrete blowout are available with sizes from 50NB/2" to 125NB/5".
- All sizes of Crane Bin feature four-way entry fork pockets, providing easy access and manoeuvre around site.
- Stackable for efficient, space-saving storage and transportation.
- Customisable with castor wheels, if required.

SPECIFICATION

THE RANGE



CODE	TYPE	WEIGHT (kg)	SWL* (kg)	CAPACITY (litres)
CA249-00850	Small 850	186	2000	850
CA249-01320	Intermediate 1320	307	2000	1320
CA249-02460	Large 2460	620	5000	2460
CA249-02530	Large 2530	448	2000	2530

*Safe Working Load

SPECIFICATION

CRANE BIN

ITEM	PRODUCT CODE
Small Crane Bin 850	CA249-00850
Intermediate Crane Bin 1320	CA249-01320
Large Crane Bin 2460	CA249-02460
Large Crane Bin 2530	CA249-02530

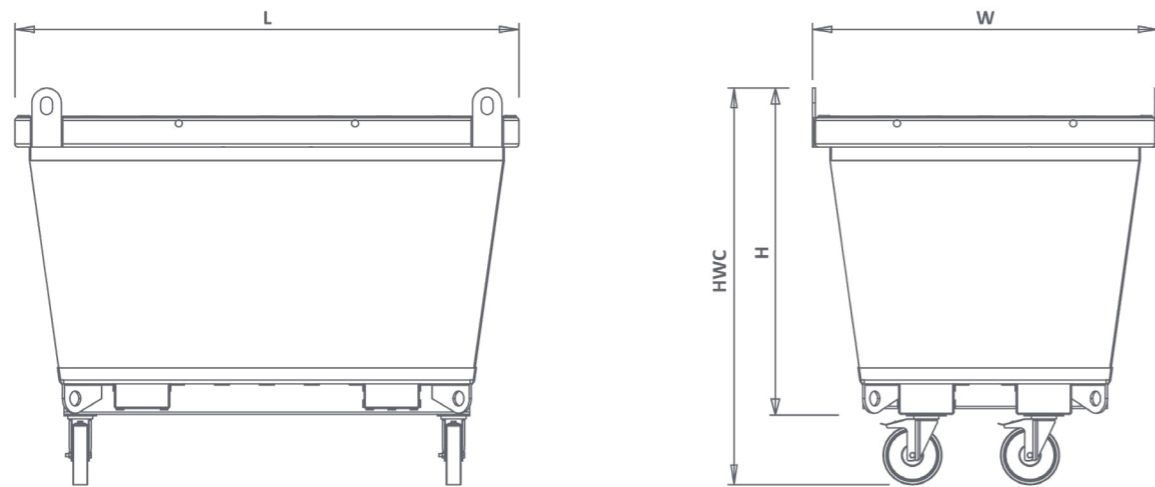

LENGTH (mm)	WIDTH (mm)	HEIGHT (mm)	HWC* (mm)
1156	1156	1100	1350
1716	1156	1100	1350
2316	1516	1100	1350
2316	1516	1100	1350

*HWC = Height With Castors

SPECIFICATION

CONCRETE BLOWOUT LID

ITEM	PRODUCT CODE
Small Concrete Blowout Bin Lid 850	ZZ120401
Intermediate Concrete Blowout Bin Lid 1320	ZZ120402
Large Concrete Blowout Bin Lid 2460	ZZ120403
Large Concrete Blowout Bin Lid 2530	ZZ120404

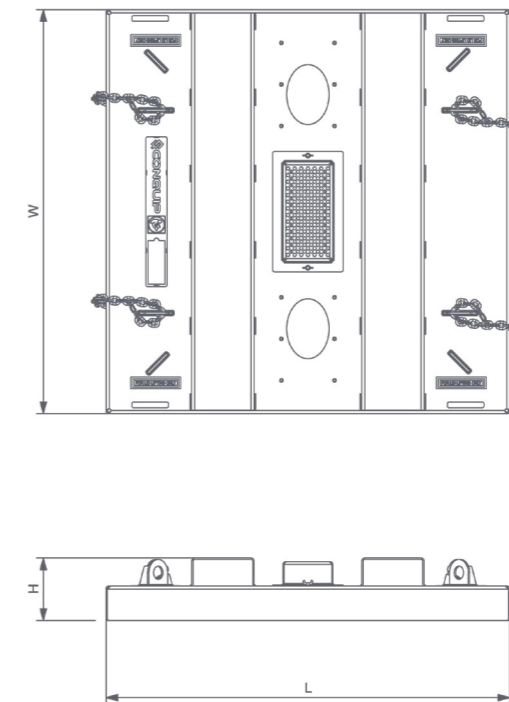

LENGTH (mm)	WIDTH (mm)	HEIGHT (mm)	WEIGHT (kg)
1220	1220	190	95
1780	1220	190	120
2360	1560	190	220
2380	1580	190	225

SPECIFICATION

WASTE PIPE & BLANKING PLATE KITS

ITEM	PRODUCT CODE
Blanking Plate Kit	ZZ120409
50NB (2") Waste Pipe Kit	ZZ120405
75NB (3") Waste Pipe Kit	ZZ120406
100NB (4") Waste Pipe Kit	ZZ120407
125NB (5") Waste Pipe Kit	ZZ120408

BLANKING PLATE KIT

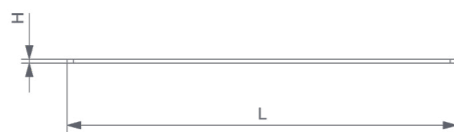

WASTE PIPE KIT

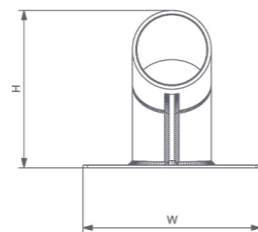
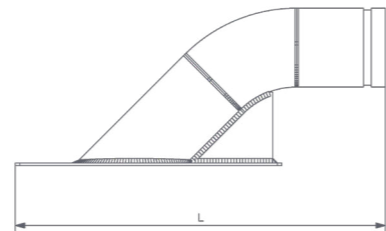

LENGTH (mm)	WIDTH (mm)	HEIGHT (mm)	WEIGHT (kg)
300	200	3	2
410	200	165	5
420	200	180	7
425	200	190	11
440	200	205	16

PARTS DIAGRAM

CONCRETE BLOWOUT LID

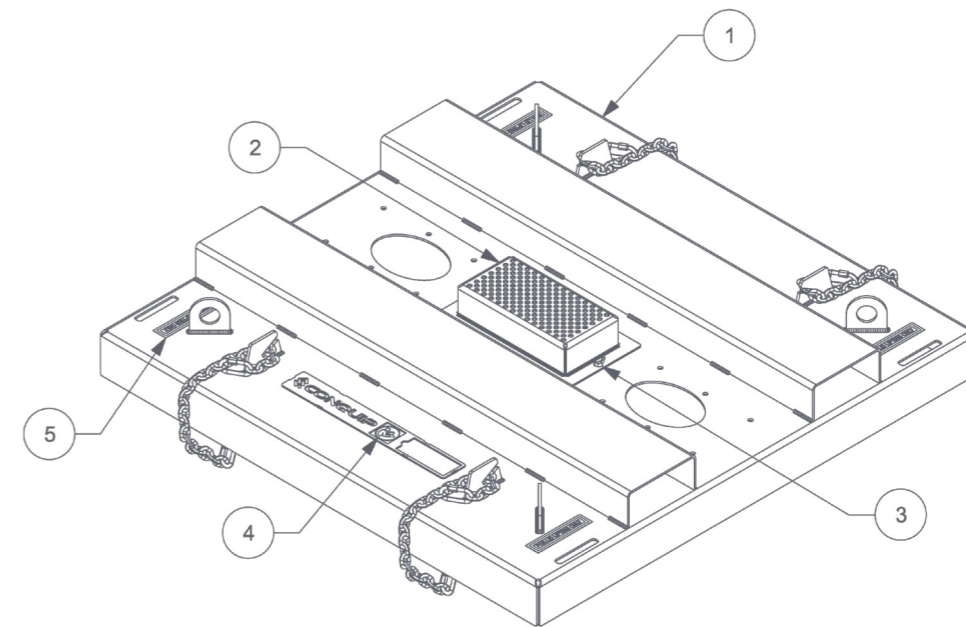

ITEM NUMBER	PART	DESCRIPTION	QUANTITY
1	0044561	WA Concrete Blowout Lid 850L	1
	0044728	WA Concrete Blowout Lid 1320L	
	0044810	WA Concrete Blowout Lid 2460L	
	0044773	WA Concrete Blowout Lid 2530L	
2	0044564	WA Exhaust Vent	1
3	0024132	Wing Screw M8 x 20LG	2
4	0019176	Decal 'Refer To Instruction Manual'	1
5	0044696	Decal 'For Lid Lifting Only'	4

PARTS DIAGRAM

CONCRETE WASTE PIPE KITS

BLANKING PLATE KIT

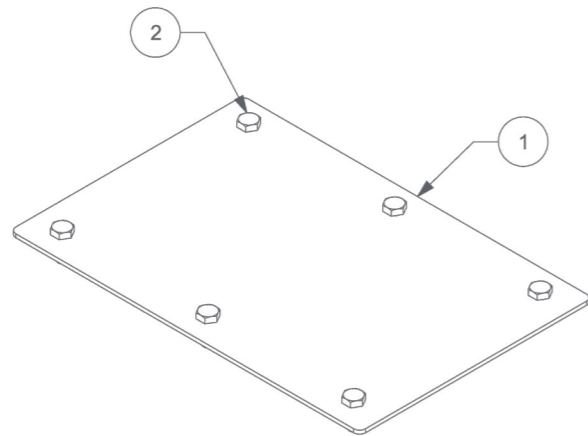

WASTE PIPE KIT

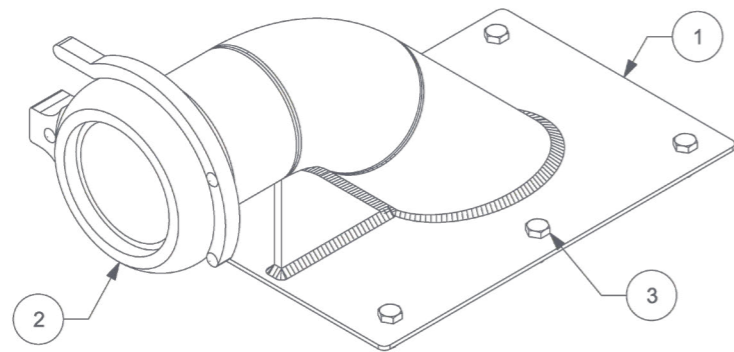

BLANKING PLATE KIT

ITEM NUMBER	DESCRIPTION	QUANTITY
1	Blanking Plate	1
2	Hex Head Screw M8X1.25 X 20LG	6

NOTE: These parts are for this model, they may differ for previous versions. Please contact Conquip with any queries.

PARTS DIAGRAM

CONCRETE WASTE PIPE KITS

50NB (2") PIPE KIT

ITEM NUMBER	DESCRIPTION	QUANTITY
1	WA 2" Waste Pipe	1
2	2" Snap Joint Coupling	1
3	Hex Head Screw M8X1.25 X 20LG	6

75NB (3") PIPE KIT

ITEM NUMBER	DESCRIPTION	QUANTITY
1	WA 3" Waste Pipe	1
2	3" Snap Joint Coupling	1
3	Hex Head Screw M8X1.25 X 20LG	6

100NB (4") PIPE KIT

ITEM NUMBER	DESCRIPTION	QUANTITY
1	WA 4" Waste Pipe	1
2	4" Snap Joint Coupling	1
3	Hex Head Screw M8X1.25 X 20LG	6

125NB (5") PIPE KIT

ITEM NUMBER	DESCRIPTION	QUANTITY
1	WA 5" Waste Pipe	1
2	5" Snap Joint Coupling	1
3	Hex Head Screw M8X1.25 X 20LG	6

NOTE: These parts are for this model, they may differ for previous versions. Please contact Conquip with any queries.

OPERATIONAL PROCEDURES

IMPORTANT USAGE NOTES

CRANE BIN

- Do not use the Crane Bin to transport toxic or dangerous materials or chemicals.
- Do not overfill the bin by volume or weight, the load should be evenly placed.
- Personnel should not be close to the bin when it is emptied.
- All lifting and tipping must be carried out by a crane. Do not attempt to move the bin by hand.
- The Crane Bin can only be transported around site with a forklift or telehandler using the four-way fork pockets.
- Do not attempt to tip or empty the bin using a forklift or telehandler.
- Do not use the Crane Bin to raise or transport personnel.

CONCRETE BLOWOUT LID

- There may be more concrete remaining in the pump line after a pour than the capacity of the Crane Bin. Follow safe usage instructions for the concrete pump to ensure that the line is blown through steadily and does not discharge more concrete than the Crane Bin's capacity.
- To prevent exceeding the working load limit of the Crane Bin, Conquip advises the Crane Bin should not be lifted when laden with concrete washout mixture.
- Before using the concrete pump, refer to the manufacturer's safety and usage instructions for best practice. These instructions for 'blowout' are only a guide.
- When attaching to lifting equipment, always use a suitably-rated, certified four-leg lifting chain and ensure that the safety chains on the blowout lid are attached to the Crane Bin, securing the lid in place.

LIFTING WITH A CRANE

01. Attach a suitably-rated four-leg chain to the four designated lifting points on the top of the bin's frame.
02. Carry out a test lift to check the bin is balanced and secure and then lift the bin to the fill location.
03. Fill the bin, ensuring the load is level and does not exceed the volume or Safe Working Load.
04. Once full, raise the bin just off the ground to check the load is balanced and secure and lift it to the discharge location.
05. Lower the bin and carefully place it on the ground.
06. To empty the load, you can use the lifting points on the base of the unit to tip the bin. However, Conquip recommend following site-specific guidelines to ensure operatives comply with risk assessment method statements (RAMS).

LIFTING WITH A FORKLIFT

01. Set the forklift or telehandler's forks to the correct width for the bin's fork pockets.
02. Drive the telehandler to the bin and align the forks with the bin's fork pockets.
03. Fully insert the forks into the bin's fork pockets.
04. Raise the bin just off the ground to check for balance, then tilt the forks backwards to prevent the bin slipping off during transit.
05. Drive the forklift or telehandler to the desired location and slowly lower the forks to the ground, carefully placing the bin on the ground.
06. Reverse the machine until the forks are fully clear of the bin's fork pockets.

USING THE CONCRETE BLOWOUT LID

01. The concrete blowout lid should be safely lifted using a forklift, a crane or other suitable lifting apparatus and placed over the top of the Crane Bin.



02. If using a forklift, insert the fork tines fully into the fork pockets of the lid. Then raise and manoeuvre, placing the lid carefully on top of the Crane Bin.

03. If using a crane or similar, attach a suitably-rated four-leg lifting chain to the four lifting points of the lid. Lift and manoeuvre, placing the lid carefully on top of the Crane Bin.

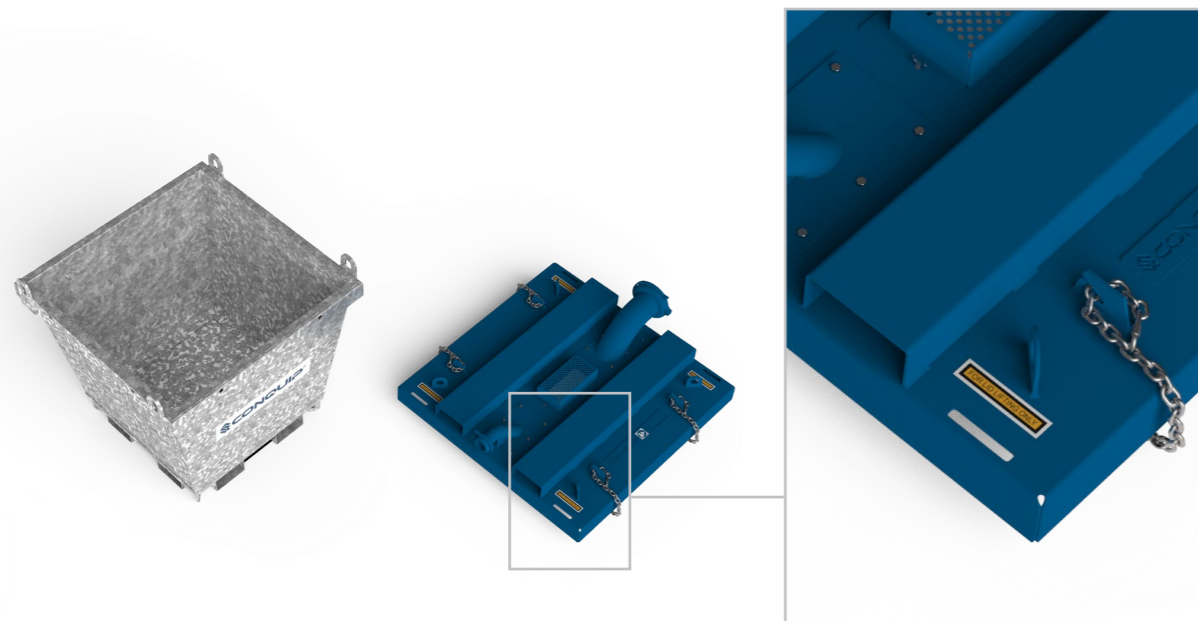

04. Once the lid has been placed on top of the Crane Bin, ensure the Crane Bin lifting points protrude through the concrete blowout lid.

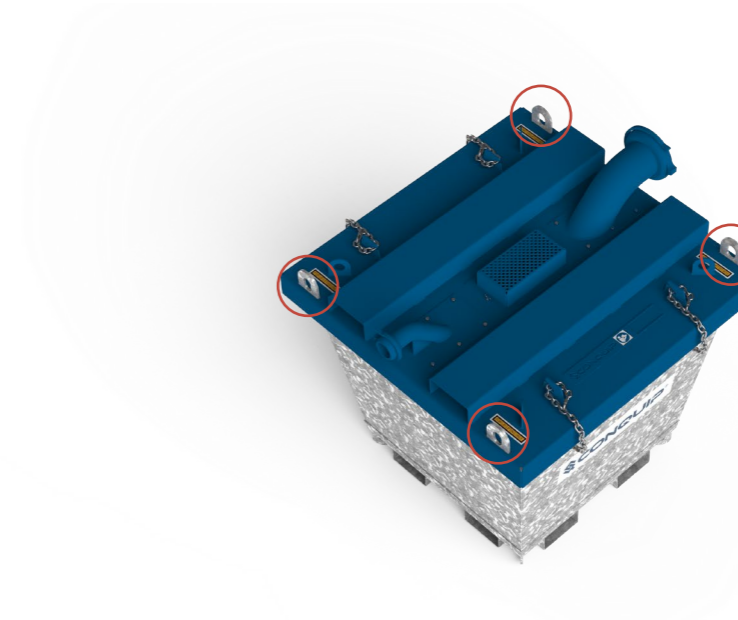

05. Once the lid is in place, secure it to the Crane Bin using the supplied safety chains. Secure the safety chain to the Crane Bin hook points and loop the chain link body through the slots in the hook plates on the lid and attach the opposite end of the chain on itself to lock the chain to the lid.

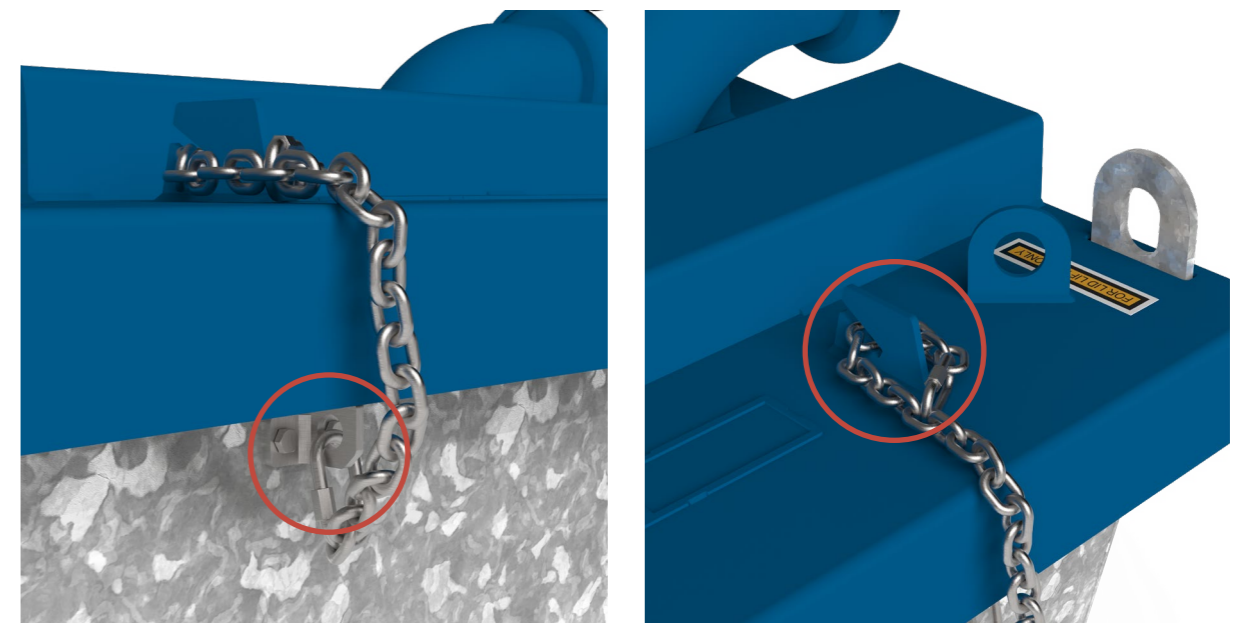

06. Once the lid is secured and locked to the Crane Bin, guide the concrete pump, aligning the end of the boom with the lid's waste pipe end and clamp the snap-joint coupling to join them.
07. Following safe usage instructions for the pump, blow the concrete pump line through and discharge the remaining concrete into the Crane Bin.
08. When the pump lines have been blown out, disconnect the placing boom. Then loosen the wing screws, remove the exhaust vent and recover the bung ('pig') from inside the Crane Bin.

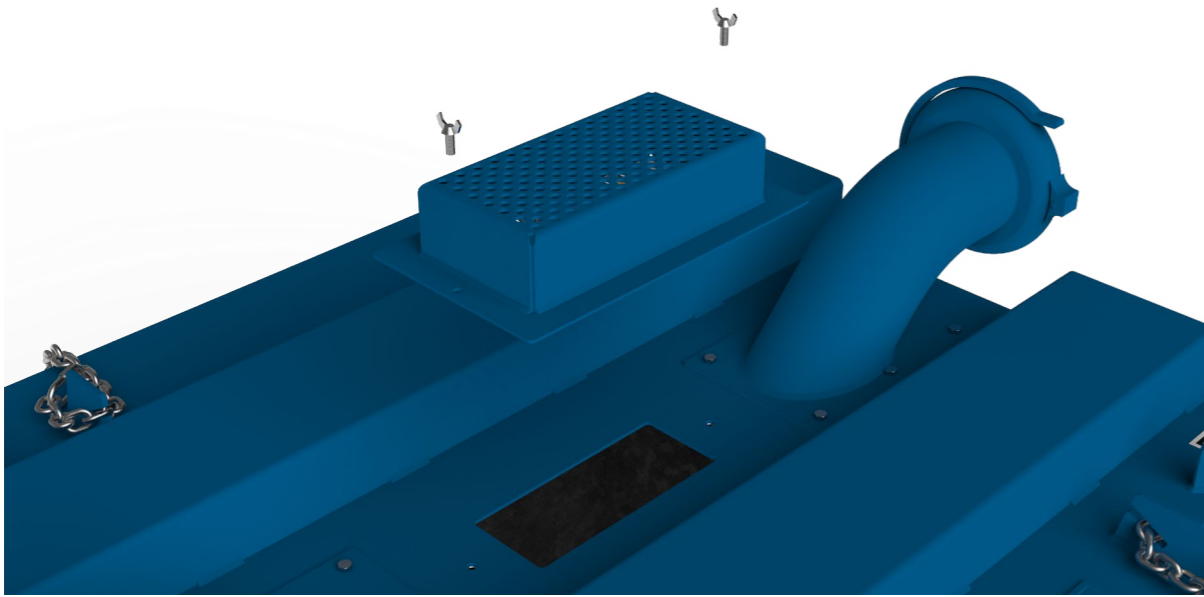

09. Replace the lid before transporting the Crane Bin, by forklift, crane or other suitable lifting apparatus, to where the concrete is required.



10. To prevent exceeding the working load limit of the Crane Bin, Conquip advises the Crane Bin should not be lifted when laden with concrete washout mixture.
11. When the concrete blowout lid is fitted, the Crane Bin can also be used to clean the concrete pump line with water by completing the same steps as used for blowout, or the best practice method suggested by the concrete pump manufacturer.
12. When the blowout and cleaning processes are complete, the lid can be removed. Both the bin and the lid can then be cleaned and the concrete wastewater removed for correct disposal according to the site's environmental regulations.

MAINTENANCE & INSPECTION

MAINTENANCE REGIME

- It is mandatory that the equipment is thoroughly examined regularly, by a qualified engineer, to ensure compliance with relevant regulations. Conquip recommend carrying out a thorough examination every six months.
- When not being used, store the unit in a clean, upright condition and in a safe place where it will be protected from thieves and unauthorised users.
- This equipment must be inspected by the responsible person before each use and then regularly, as determined by your risk assessment or working practice. If you have any concerns about the equipment’s condition or suitability, do not use it.

VISUAL INSPECTION CHECKLIST

INSPECTION ITEMS	RESULTS		COMMENTS
	SATISFACTORY	UNSATISFACTORY	
Serial Number			CQ.....
Product Code			
Working Load Limit (kg)			
Conforms to user guide specification			
Check Crane Bin lifting points condition for wear or elongation			
Check concrete blowout lid lifting points condition for wear or elongation			
Check safety chains on concrete blowout lid for wear or distortion			
Check the concrete waste pipe snap-joint coupling seal			
General visual inspection of the body			
SIGNATURE			
Name	Position	Qualification	Signature & Date

GENERAL SAFETY INSTRUCTIONS

The equipment should be properly operated and maintained to keep it in a safe, efficient operating condition. Be sure that all fixings and components are free of mud or other matter that might cause issues hazardous to the operator, serviceman, or other personnel or equipment. Report all malfunctions to those responsible for maintenance, and do not operate the equipment until corrected. Normal service or maintenance performed as required can prevent unexpected and unnecessary downtime.

This operations manual describes general inspections, servicing and operation with the normal safety precautions required for normal servicing and operating conditions. It is not a guide, however, for abnormal conditions or situations, and therefore, servicemen and operators must be safety conscious and alert to recognise potential servicing or operating safety hazards at all times, and take necessary precautions to assure safe servicing and operation of the equipment.



M002
Refer to instructions manual



M004
Wear eye protection



M008
Wear safety footwear



M009
Wear protective gloves



M010
Wear protective clothing



M014
Wear head protection



M015
Wear high-visibility clothing

GENERAL NOTES

- Read this operations manual and learn the operating characteristics and limitations of the equipment.
- Read and understand all the safety signs prior to operation.
- If the safety signs are obstructed by dirt or debris, clean them using mild soap and water prior to operation.
- If the safety signs are damaged or illegible, replace them immediately, prior to operation.
- Be aware of operating hazards that weather changes can create on the job. Know proper procedures to follow when a severe rain or electrical storm strikes.
- Never attempt to operate or work on machinery when not feeling physically fit.
- Never wear loose clothing, rings, watches, heavy gloves etc., that might catch and result in injury.
- Know what safety equipment is required and use it. Such equipment may be: hard hat, safety glasses, reflector type vests, protective gloves and safety footwear.

TERMS & CONDITIONS

CONQUIP ENGINEERING GROUP STANDARD PRODUCT WARRANTY

01. COMMENCEMENT

1.1 This Warranty shall commence on the Commencement Date and shall continue until the earlier of:

- (a) the Expiry Date; or
- (b) the date on which it may be voided in accordance with clause 4.1(b)

when it shall terminate automatically without notice.

02. DUTY OF GOOD FAITH

2.1 The Purchaser shall in the exercise of its rights under this Warranty and in the compliance with its obligations under this Warranty be subject to and shall in all respects owe and comply with a duty of good faith to the Warrantor.

03. NATURE AND EXTENT OF COVER

3.1 Subject to clause 3.2 the Warrantor agrees and undertakes to the Purchaser that it shall be liable to the Purchaser under and in accordance with the terms of this Warranty in the event that:

- (a) prior to the Expiry Date the Purchaser shall notify a Warranty Claim to the Warrantor; and
- (b) the Equipment or any relevant part of the Equipment shall have become unusable as the result of defective material or defective workmanship prior to the Expiry Date.

3.2 The Warrantor's obligation under clause 3.1 shall be expressly subject to the provisions of clauses 4, 5 and 6 and conditional upon the Purchaser's compliance in full with the provisions of clause 7.

04. RESTRICTIONS

4.1 The following restrictions apply to this Warranty:

(a) This Warranty is personal to the Purchaser and neither the legal benefit nor legal burden of this warranty may be assigned or novated or otherwise transferred by the Purchaser to any other party. Any purported assignment, novation or transfer shall not be binding upon the Warrantor.

(b) This Warranty shall be void in the event that the Purchaser:

(i) cannot provide authentic and original documentary evidence that the Purchaser has during the period between the Commencement Date and the Expiry Date complied with the Maintenance and Servicing Requirements; and/or

(ii) has, during the period between the Commencement Date and the Expiry Date, exceeded the Purchaser's Usage Cycle Parameters; and/or

(iii) has, during the period between the Commencement Date and the Expiry Date, exceeded the Purchaser's Use Parameters; and/or

(iv) has carried out, or procured the carrying out by any third party of, any repair to the Equipment or any part of the Equipment which is not an Authorised Repair; and/or

(v) has operated the Equipment after having replaced any part of the Equipment with a part which has not been supplied and fitted by the Warrantor; and/or

(vi) has modified the Equipment in any way prior to use.

05. EXCLUSIONS

5.1 The following are excluded from the scope of this Warranty:

(a) Loss of and/ or damage to the Equipment or any part of it resulting from any collision between the Equipment and any other fixed or stationary or mobile object whatsoever, irrespective of whether that collision was or was not caused by the Purchaser; and/or

(b) Loss of and/or damage to any personal property and/or possessions or other equipment not forming part of the Equipment but which is present in or about the Equipment; and/or

(c) loss and/or damage which is covered by any other insurance policy taken out and maintained by the Purchaser or in respect of which the Purchaser has a contractual obligation to do so; and/or

(d) loss and/or damage to the equipment which is consistent with the use by the Purchaser of the Equipment:

(i) in compliance with the Maintenance and Servicing Requirements; and

(ii) in compliance with the Usage Cycle Parameters; and

(iii) in compliance with the Use Parameters; and

(iv) having only carried out Authorised Repairs to the Equipment; and

(v) having all and any replacement parts fitted by the Warrantor; and

(vi) in unmodified form.

06. LIMITATION OF LIABILITY

6.1 The Warrantor's liability to the Purchaser shall be limited as follows:

- (a) The Warrantor shall not in any circumstances be liable to the Purchaser for indirect and/or consequential and/or economic loss suffered and/or incurred as the case may be by the Purchaser; and
- (b) The Warrantor shall only be liable to the Purchaser for the reasonable and proper costs reasonably and properly incurred by the Purchaser directly in connection with the repair and/or replacement (at the Warrantor's absolute discretion) of the Equipment or any part of the Equipment; and
- (c) The Warrantor's liability to the Purchaser shall notwithstanding any other provision of this Warranty, not in any circumstances exceed the Purchase Price of the Equipment.

07. WARRANTY CLAIMS

7.1 The Purchaser shall in respect of any claim against the Warrantor under this Warranty and within 24 hours of the occurrence of the subject matter of the Warranty Claim:

- (a) Complete in full and submit to the Warrantor a Warranty Claim in the form annexed to Schedule 4;
- (b) Provide date stamped or date identifiable photographs evidencing the claim; and
- (c) Make the Equipment or the relevant part of the Equipment available to the Warrantor for inspection within 48 hours of notification of the relevant Warranty Claim.

08. ENTIRE AGREEMENT

8.1 This Warranty constitutes the entire agreement between the parties and supersedes and extinguishes all previous promises, assurances, warranties, representations and understandings between them, whether written or oral, relating to its subject matter.

8.2 Each party agrees that it shall have no remedies in respect of any statement, representation, assurance or warranty (whether made innocently or negligently) that is not set out in this Warranty. Each party agrees that it shall have no claim for innocent or negligent misrepresentation or negligent misstatement based on any statement in this Warranty.

No variation of this Warranty shall be effective unless it is in writing and signed by the parties (or their authorised representatives).

09. WAIVER

No failure or delay by a party to exercise any right or remedy provided under this Warranty or by law shall constitute a waiver of that or any other right or remedy, nor shall it prevent or restrict the further exercise of that or any other right or remedy. No single or partial exercise of such right or remedy shall prevent or restrict the further exercise of that or any other right or remedy.

10. SEVERANCE

10.1 If any provision or part-provision of this Warranty is or becomes invalid, illegal or unenforceable, it shall be deemed deleted, but that shall not affect the validity and enforceability of the rest of this Warranty.

10.2 If any provision or part-provision of this Warranty is deemed deleted under clause 10.1 the parties shall negotiate in good faith to agree a replacement provision that, to the greatest extent possible, achieves the intended commercial result of the original provision.

11. THIRD PARTY RIGHTS

11.1 This Warranty does not give rise to any rights under the Contracts (Rights of Third Parties) Act 1999 to enforce any term of this Warranty.

12. GOVERNING LAW

12.1 This Warranty and any dispute or claim (including non-contractual disputes or claims) arising out of or in connection with it or its subject matter or formation shall be governed by and construed in accordance with the law of England and Wales.

13. JURISDICTION

13.1 Each party irrevocably agrees that the courts of England and Wales shall have exclusive jurisdiction to settle any dispute or claim (including non-contractual disputes or claims) arising out of or in connection with this Warranty or its subject matter or formation.

EC DECLARATION OF CONFORMITY

IN ACCORDANCE WITH EN ISO 17050-1:2004

Declaration: As defined by the Machinery Directive 2006/42/EC and subsequent amendments

We, CONQUIP ENGINEERING GROUP, herewith declare that the following indicated equipment meets the fundamental health and safety requirements concerning the EU guideline(s), due to their design and manufacture.

This declaration will be rendered null and void if the machine is changed without our approval.

SIGNED:



DATED: 2025

Garry Critchley, Chief Executive Officer

PRODUCT CODES	GENERAL DESCRIPTION / DESIGNATION	SAFE WORKING LOAD
CA249-00850	Small Crane Bin 850	2000kg
CA249-01320	Intermediate Crane Bin 1320	2000kg
CA249-02460	Large Crane Bin 2460	5000kg
CA249-02530	Large Crane Bin 2530	2000kg

ITEM	CODE	DESCRIPTION
EC DIRECTIVE/REGULATION	2006/42/EC	Directive 2006/42/EC- new machinery directive
HARMONISED STANDARDS	BS EN ISO 12100:2010	Safety of machinery General principles for design Risk assessment and risk reduction
	BS EN 1993-1-1: 2005	Eurocode 3. Design of steel structures General rules and rules for buildings
OTHER REGULATIONS	LOLER 1998	Lifting Operations and Lifting Equipment Regulations 1998 (LOLER)
	PUWER 1998	Provision and Use of Work Equipment Regulations 1998 (PUWER)

TALKING TO US IS EASY
WE'RE HERE TO HELP

Call us on (02) 8844 4590
Email us at sales@conquipgroup.com.au
www.cqegroup.com/au

